

# 2023

# *Jefferson County*



# Mini Handbook



Extension - Jefferson County

---

3767 W SR 256  
Madison, IN 47250

Phone: (812) 265- 8919

# **About Jefferson County 4-H**

## **What is 4-H?**

4-H prepares young people to be leaders in their community and around the world through hands-on experiences alongside their peers and caring adults. Backed by a network of more than 6 million youth, 540,000 adult volunteers, 3,500 professionals, and more than 60 million alumni; 4-H delivers research-based programming around positive youth development. 4-H is delivered through America's 109 land-grant universities and the Cooperative Extension Service – reaching every corner of our nation.

In Indiana, 4-H can be found in all 92 counties as delivered through Purdue Extension. Community clubs, afterschool programs, school enrichment, camps/workshops, 4-H fairs, and special programs are all ways youth across Indiana can be involved with the 4-H program.

## **Who can participate?**

Youth in grades 3-12 are invited to be a part of the 4-H Program. Mini 4-H is offered as a non-competitive option for grades K-2.

## **How to get involved?**

First, you need to enroll in the 4-H program via the 4-H Online website [v2.4honline.com](http://v2.4honline.com). During the enrollment process, you will select a 4-H Club. For information on 4-H Clubs consult the club directory in the following pages. Your 4-H Club will host meetings and provide additional resources for you to stay involved in 4-H throughout the year.

## **New to 4-H?**

Welcome! We are happy to have you as part of the Jefferson County 4-H Program. The 4-H Educators are your primary contacts for all things 4-H. Need help with enrollment? Interested in joining a 4-H Club? Do you have questions about a project for fair? Contact your 4-H Educators via the contact information below so that they can help you navigate your 4-H experience!

## **Purdue Extension Jefferson County Contact Information:**

(812) 265-8919

3767 W State Road 256, Madison, IN. 47250

Britt Copeland – 4-H Educator: [copelanb@purdue.edu](mailto:copelanb@purdue.edu)

Jessica Martini – 4-H Educator: [koons0@purdue.edu](mailto:koons0@purdue.edu)

Bess Adams – Program Assistant: [bladams@purdue.edu](mailto:bladams@purdue.edu)

Kasie Bachmann – Office Manager: [kbachman@purdue.edu](mailto:kbachman@purdue.edu)

## Table of Contents

<i>2023 Fair Schedule</i> .....	v
<i>Important Dates for all Jefferson County 4-H Members</i> .....	vi
<i>Jefferson County 4-H Club Directory</i> .....	viii
<i>4-H Website Directory</i> .....	x
<i>Project Title: Mini 4-H Arts and Crafts</i> .....	1
<i>Project Title: Mini 4-H Cake Decorating</i> .....	2
<i>Project Title: Mini 4-H Entomology</i> .....	3
<i>Project Title: Mini 4-H Floriculture</i> .....	4
<i>Project Title: Mini 4-H Foods</i> .....	5
<i>Project Title: Mini 4-H Forestry</i> .....	6
<i>Project Title: Mini 4-H Garden</i> .....	7
<i>Project Title: Mini 4-H Geology</i> .....	8
<i>Project Title: Mini 4-H Health</i> .....	9
<i>Project Title: Mini 4-H Pets</i> .....	10
<i>Project Title: Mini 4-H Sewing</i> .....	11
<i>Project Title: Mini 4-H Wildlife</i> .....	12
<i>Special Awards Offered</i> .....	14
<i>Scholarship Opportunities</i> .....	15
<b>M E M O R I A L S</b> .....	16
<i>2022 Special Contributors</i> .....	16
<i>Special Fair Time Events</i> .....	13
<i>Jefferson County 4-H Adult Volunteers 2023</i> .....	18
<i>2022 Trophy Sponsors</i> .....	19
<i>4-H Poster Pointers</i> .....	20

## Jefferson County 4-H Fair Board

The Jefferson County 4-H Fair Board is the policy making board for the Jefferson County 4-H program. Members are elected by the active membership of the 4-H program. Meetings are open to the 4-H membership and are held on the first Thursday of the month at 7 pm in the community building unless otherwise advertised in the extension newsletter.

**Scott Hubbard** –President & Pavilion Entertainment

**Tanner Mahoney** – Vice President

**Larry Sedam** – Secretary

**Mary Ellen Wehner** – Treasurer

**Billy Keller** – Grandstand, Buildings, & Grounds

**Brice Gray** – Buildings and Grounds

**Emerson Coles** – Roads & Grandstand

**Bill Miller** – Roads & Parking

**Linda Schimfessel** – Livestock Auction

**Aaron Clayton** – Merchant Building

**Michael Hazelwood** – Grounds

**Ashley Shepherd** – Community Building

**Tim McDonough** – Building & Grounds

**Rick Stockdale** – Front Gates

**Bill Cain** – Concessions

**Alinza Deuser** – 4-H Leader Representative

**Carol Bell** – Extension Homemaker Representative

**Shelby Morton** – 4-H Junior Leader Representative

**Ella Grace Morris** – 4-H Junior Leader Representative

**Britt Copeland** – Ex. Officio. Purdue Extension Educator

**Jessica Martini** – Ex. Officio. Purdue Extension Educator

### Annual Fair Board Meeting Information

The Annual Fair Board Meeting is held every year on the last Saturday of Fair at 2:00pm in the Community Building. New members are elected to the Fair Board at this time. There is also a discussion of the fair and recommendations are heard. No action is taken on any recommendations until the next Fair Board Meeting after this annual meeting. New members appointed to the Jefferson County 4-H Fair Board are required to complete a volunteer application, sign a Behavioral Expectations form, complete Youth Safety Training, and complete a background check prior to being formally accepted onto the board.

Members whose terms are expiring this year include; Linda Schimfessel, Scott Hubbard, Mike Hazelwood, Tanner Mahoney and Tim McDonough.

## 2023 Fair Schedule

### Thursday, July 6<sup>th</sup>

4:00pm-7:00pm – Project Check-In for Exhibit Hall 4-H & Mini 4-H Projects

### Friday, July 7<sup>th</sup>

3:00pm-7:00pm – Enter Poultry and Rabbits

### Saturday, July 8<sup>th</sup>

7:00am-9:00am – Enter Swine

8:30am-11:30am – Enter Open Class

10:00am – 4-H Poultry & Other Fowl Show

10:00am – 4-H Dog Obedience & Agility

**2:30pm-4:30pm – Enter Beef**

4:00pm-9:00pm – 4-H & Open Class

Exhibit Halls Open

4:30pm – 4-H Tractor Operator Contest

### Sunday, July 9<sup>th</sup>

1:00pm-4:00pm – Enter Sheep & Goats (check with Superintendents prior to penning)

1:00pm – 4-H Horse Show – English & Contesting

4:00pm-9:00pm – 4-H & Open Class

Exhibit Halls Open

7:00pm – Tots and Tykes

### Monday, July 10<sup>th</sup>

6:00am – 4-H Livestock Auction Pictures (show attire recommended)

6:00am – Beef, 6:30am – Swine, and

7:00am – Sheep

6:00am-11:00am – Enter Dairy Heifers

9:00am – 4-H Rabbit Show

10:00am – Hutchinson Award Sheep Test

4:00pm-9:00pm – 4-H & Open Class

Exhibit Halls Open

5:30pm – 4-H Goat Show

7:00pm – Tots and Tykes

### Tuesday, July 11<sup>th</sup>

8:30am – 4-H Horse Show – Western

4:00pm-9:00pm – 4-H & Open Class

Exhibit Halls Open

5:00pm – 4-H Swine Show

### Wednesday, July 12<sup>th</sup>

9:30am – Farm Bureau Kiddie Tractor Pull

10:00am – 4-H Dairy Show

2:00pm – Poultry & Rabbit Ambassador Test

2:00pm – 4-H Cat Show

4:00pm-9:00pm – 4-H & Open Class

Exhibit Halls Open

5:00pm – 4-H Sheep Show

### Thursday, July 13<sup>th</sup>

8:00am – 4-H Beef Show

2:30pm – 4-H Club Challenge

4:00pm-9:00pm – 4-H & Open Class

Exhibit Halls Open

7:00pm – Mini 4-H Barn Blast

### Friday, July 14<sup>th</sup>

1:00pm – 4-H Livestock Auction

4:00pm-9:00pm – 4-H & Open Class

Exhibit Halls Open

5:00pm – Auction Dinner

6:30pm – Round Robin Showmanship

**11pm- Midnight – Livestock, Horse & Pony, Rabbit and Poultry Release/Clean Up**

*Must be cleared with Superintendent*

### Saturday, July 15<sup>th</sup>

10:00am-12:00pm – Open Class Exhibits Released

12:00pm-4:00pm – 4-H Exhibits Released

2:00pm – Annual Fair Board Meeting

4:00pm – 4-H Awards Program

5:00pm-6:00pm – 4-H Exhibits Released

# Important Dates for all Jefferson County 4-H Members

The following is the general layout of a calendar year in the Jefferson County 4-H Program. All dates are published in the monthly Purdue Extension Jefferson County Newsletter that is sent to all 4-H families via mail and the family email associated with your 4-H Online account. This is our official source of communication; any changes or deadlines will be published in your newsletter. Dates are subject to change.

## October 1- January 15

- Enroll or reenroll in 4-H via v2.4honline.com. **January 15 is the Target Enrollment Date for 4-H.** Members are able to enroll after January 15<sup>th</sup> but the office transitions their mailing list at that date.

## January 25

- **Indiana 4-H Scholarships** are due for 10-12<sup>th</sup> graders on 4HOnline. Contact Extension office for more information.

## February 1

- **Annual Extension Board Meeting and 4-H Leader Recognition Dinner.**

## February 10

- **Jefferson County 4-H Scholarships** are included on the community foundation application due on February 10<sup>th</sup>. Contact your school counselor for more information.

## April 15

- **Tagging Day for Beef and Dairy Beef Steers-** 7 – 10 am in the Hog Barn at the Fairgrounds.
  - Animals tagged at a previous tagging day do not need to return.
  - If you plan to show at the **Indiana State Fair** you will need additional tags and a DNA hair sample taken at tagging.
  - **Born & Bred Heifer Enrollment Form Due at Tagging.**

## April 29

- **Tagging Day for all Goats, Sheep, and Swine-** 7- 10 am at the Fairgrounds.
  - Animals tagged at a previous tagging day do not need to return.
  - If showing at the **Indiana State Fair** you will need additional tags and a DNA hair sample taken at tagging.

## ○ Swine Members:

- **Ractopamine Affidavits are due at tagging.**
- **Born and Bred Gilt & Ewe Enrollment Form due at tagging.**

## May 1

- Animal Lease Agreements are due to the extension office.

## May 15

- **4-H Online Animal Enrollment Deadline.**
  - Extension Staff will be set up at Tagging Days with computers to help exhibitors. Animals not at tagging still need to be enrolled by this date.
  - Rabbit, Poultry, Dogs and Cats do not have to be registered.

## June 1

- Entry discounts end for the Indiana State Fair Livestock and Animal Shows.
- **Fair Entry** open to enroll exhibits. Deadline is June 30

## June 5-9

- **Southeastern Indiana 4-H Camp** at Camp Higher Ground for 4-H members in grades 3-12. Contact the extension office to learn more.

## June 7-9

- **4-H Academy @ Purdue University,** youth in grades 9-12. More information on joinindiana4h.org.

## June 13-16

- **State 4-H Junior Leaders Conference**

## June 26-28

- **4-H Round Up @ Purdue,** youth in grades 7-8. More information on joinindiana4h.org.

## June 30

- **FairEntry Closes**

## Jefferson County 4-H Club Directory

<b>General Interest Clubs:</b>		
<b>Name:</b>	<b>Meeting Info:</b>	<b>Leaders</b>
Canaan 4-H	<u>Date:</u> 3 <sup>rd</sup> Sunday of the Month <u>Time:</u> 2:00 p.m. <u>Location:</u> Indian-Kentuck Baptist Church	Penny Brim Alyssa Shelton Brittany Hitchel
Deputy 4-H Family and Friends	<u>Date:</u> 2 <sup>nd</sup> Sunday of the Month <ul style="list-style-type: none"> <li>• Feb. 12<sup>th</sup></li> <li>• March 12<sup>th</sup></li> <li>• April 23<sup>rd</sup></li> <li>• May 21<sup>st</sup></li> <li>• June 4<sup>th</sup></li> </ul> <u>Time:</u> 2:30 p.m. <u>Location:</u> Community Building <u>Facebook Group:</u> <a href="https://facebook.com/groups/578648583067865">facebook.com/groups/578648583067865</a>	Alexis Napier Andrea Copeland Brittany Copeland Erika Hazelwood
Four Leaf Clovers	<u>Date:</u> 2 <sup>nd</sup> Sunday of the Month Feb-Jun <u>Time:</u> 2:00 p.m. <u>Location:</u> Nutrien Ag <u>Facebook Group:</u> <a href="https://facebook.com/groups/376474488496">facebook.com/groups/376474488496</a>	Heather Huff Brandy Graham
Hanover No-Names	<u>Date:</u> Monthly (March-June) <u>Time:</u> 6:30 p.m. <u>Location:</u> Community Building <u>Facebook Group:</u> <a href="https://facebook.com/groups/hanovernonames">facebook.com/groups/hanovernonames</a> <u>Leaders:</u> Zach & Taylor Hubbard Binnie Phillips	Krista Coles Terry Phillips Michelle Hubbard Tanner Mahoney Brent Wehner Megan Wehner Larry & Tammy Sedam Tara Cash
Happy Hoosiers	<u>Date:</u> 2 <sup>nd</sup> or 4 <sup>th</sup> Thursday each Month <u>Time:</u> 7:00 p.m. <u>Location:</u> Rykers Ridge Firehouse <u>Leaders:</u> Jennifer Abbott Judy Elston Sharon Schafer	Bridget Leach Judy Smith Jennifer Ranson Sharon Schafer Sara Schafer Linda Schimfessel Amy Stuart
Homegrown 4-H Club	<u>Date:</u> TBD <u>Time:</u> TBD <u>Location:</u> TBD	Hannah Shelton Marla Brennan
Jefferson County Town & Country	<u>Date:</u> 1 <sup>st</sup> Sunday - Monthly <u>Time:</u> 3:00 p.m. <u>Location:</u> Wirt Baptist Church <u>Facebook Group:</u> <a href="https://facebook.com/groups/148984645238227">facebook.com/groups/148984645238227</a>	Mary Mehl Crystal Field Renee Glunt

Kent Klover Club	<u>Date:</u> Tuesday/Thursday Monthly <ul style="list-style-type: none"> <li>• Thurs., March 9th</li> <li>• Tues., April 4<sup>th</sup></li> <li>• Tues., May 9<sup>th</sup></li> <li>• Tues., June 6<sup>th</sup></li> <li>• Thurs., June 29<sup>th</sup></li> </ul> <u>Time:</u> 6:30 p.m. <u>Location:</u> Community Building <u>Facebook Group:</u> <a href="https://facebook.com/groups/1716830195235450">facebook.com/groups/1716830195235450</a>	Amanda Whelan Linda Gray Jill Deputy Brice Gray Ashley Gray Brent Gray Caitlyn Gray
Saluda Kountry Kids	<u>Date:</u> TBD <u>Time:</u> TBD - 6:00/6:30 p.m. <u>Location:</u> Community Building <u>Facebook Page:</u> <a href="https://facebook.com/profile.php?id=100064778318236">facebook.com/profile.php?id=100064778318236</a>	Ryan Leach Tim McDonough Cassandra Rudolph
Young Country	<u>Date:</u> TBD - Sundays <u>Time:</u> 3:00 p.m. <u>Location:</u> Community Building <u>Facebook Group:</u> <a href="https://facebook.com/groups/828273390575621">facebook.com/groups/828273390575621</a>	Erica Bechman Shanna Smith Chance Bechman Carrie Bechman
Smyrna Star Searchers	<u>Date:</u> TBD - April-June Weekly <u>Time:</u> 6:00pm <u>Location:</u> Nevill's Grove	Cindy Mack Melissa Waller
Willing Workers	<u>Date:</u> TBD – Monthly <u>Time:</u> 6:30 p.m. <u>Location:</u> Community Building <u>Facebook Page:</u> <a href="https://facebook.com/WillingWorkers4HClub">facebook.com/WillingWorkers4HClub</a>	Tristin & Chris Imel Alinza Deuser



# 4-H Website Directory

Site	Purpose
 <p>4-H ENROLLMENT AND EVENT REGISTRATION</p>	<p><a href="http://v2.4honline.com">v2.4honline.com</a></p> <p>Enrollment Portal for the entire state. Members and Volunteers must enroll in 4-H on this website each year. This website is how we send newsletters, how members apply for scholarships, state trips, choose clubs and projects and how volunteers complete required trainings.</p> <p><b>Important Dates:</b> January 15: Target Enrollment Date May 15: Animal ID Deadline (excluding Poultry, Rabbits, Cats and Dogs)</p>
	<p><a href="http://jeffersoncounty.fairentry.com">jeffersoncounty.fairentry.com</a></p> <p>This is the portal we use to enter what classes and divisions members will show their projects in at the fair. We use this site to print back numbers, print show bills, prepare ribbons and trophies and assign stalls. Your animals must be registered on 4honline first and will transfer over. Use your 4honline credentials to log into this site.</p> <p><b>Important Dates:</b> Open June 1- 30</p>
 <p>Extension - Jefferson County</p>	<p><a href="http://extension.purdue.edu/county/Jefferson">extension.purdue.edu/county/Jefferson</a></p> <p>This is our Purdue Extension Jefferson County webpage. Here you will find not only 4-H but Agriculture and Natural Resource &amp; and Health and Human Sciences programing information. If you click on Jefferson County 4-H you will be directed to our 4-H homepage. Here you can find an electronic version of the <b>Handbook</b>, an archive of all <b>newsletters</b>, links to all relevant 4-H sites and a <b>community building calendar</b> that shows when 4-H clubs are meeting on the fairgrounds.</p>
	<p><a href="http://exhibitorscorner.indianastatefair.com">exhibitorscorner.indianastatefair.com</a></p> <p>This is the portal to register for Animal and Livestock Shows at the Indiana State Fair. Consult your handbook to make sure your animal is properly identified for State Fair with ear tags and DNA sample submission as State Fair requirements are different than county only exhibition. Exhibit Hall and Static Projects are automatically promoted to state fair by the extension office.</p>
 <p>Extension - 4-H Youth Development</p> 	<p><a href="http://Joinindiana4h.org">Joinindiana4h.org</a></p> <p>This is the Indiana State 4-H webpage. It provides an overview of the 4-H program. On the projects page you can <b>access project resources, scorecards, record sheets, scholarship information and much more.</b></p>

# Project Title: Mini 4-H Arts and Crafts

## Description of Mini 4-H:

Mini 4-H is a program designed to encourage positive development of children, Kindergarten through 2nd grade. The goal of Mini 4-H is to help young children explore friendships outside the family; explore the way in which things work; practice both small and large muscle control; and think about the ways people work together on projects. **Mini 4-H is non-competitive.** All Mini 4-H members will receive a Mini 4-H completion ribbon.

## Exhibit Guidelines:

All Mini 4-H projects will be entered the Thursday before the start of fair at the Jefferson County 4-H Fairgrounds. Each project should have an attached name tag. After the project has been entered, it will be displayed in a special Mini 4-H section of the Exhibit Hall.

Youth may exhibit any art or craft of their choosing. Mini 4-H members are encouraged to be creative and use their imagination. **Examples of possible Mini 4-H Arts and Crafts projects include but are not limited to;**

- **Construction and Architectural Replica** – (ex. farm scenes, town models, dinosaur scenes, building replicas, Lego/block scenes etc.)
- **Fine Arts** – (ex. oil, charcoal, pastels, pencil, ink, acrylic, watercolor, or another similar medium)
- **Model Craft** – (ex. model car kit, model boat kit, etc.)
- **Needle Craft** – (knitting, embroidery, crocheting, needlepoint, etc.)
- **Gift Wrapping** – (gift wrapped box, decorative gift bag, etc.)
- **Scrapbooking** – (scrapbook of a vacation, school, club, etc.)

Exhibitors should be considerate of space. Exhibits too large to move or requiring lots of space must be exhibited using photographs and a description in a notebook. Purdue Extension Jefferson County is not responsible for any broken or misplaced items.

Mini 4-H members should also bring their completed **Mini 4-H Record Sheet** to Project Check-In for Project Superintendents to review. This record sheet will not be collected. It simply serves as a reference for the Project Superintendent and prepares Mini 4-H members for recordkeeping as regular 4-H members.

# Project Title: Mini 4-H Cake Decorating

## Description of Mini 4-H:

Mini 4-H is a program designed to encourage positive development of children, Kindergarten through 2nd grade. The goal of Mini 4-H is to help young children explore friendships outside the family; explore the way in which things work; practice both small and large muscle control; and think about the ways people work together on projects. **Mini 4-H is non-competitive.** All Mini 4-H members will receive a Mini 4-H completion ribbon.

## Exhibit Guidelines:

All Mini 4-H projects will be entered the Thursday before the start of fair at the Jefferson County 4-H Fairgrounds. Each project should have an attached name tag. After the project has been entered, it will be displayed in a special Mini 4-H section of the Exhibit Hall.

Youth may exhibit any cake decorating project of their choosing. Mini 4-H members are encouraged to be creative and use their imagination. All Mini 4-H Cake Decorating projects should be exhibited on a paper plate. **Examples of possible Mini 4-H Cake Decorating projects include but are not limited to;**

- **1 Frosted Sugar Cookie** – (ex. frosted with store-bought or homemade frosting, decorated with sprinkles, candies, etc.)
- **1 Frosted Cupcake** – (ex. frosted with store-bought or homemade frosting, decorated with sprinkles, candies, etc.)

Exhibitors should be considerate of space. Exhibits too large to safely move or requiring lots of space should be exhibited using photographs and a description of work in a notebook. Purdue Extension Jefferson County is not responsible for any broken or misplaced items.

Mini 4-H members should also bring their completed **Mini 4-H Record Sheet** to Project Check-In for Project Superintendents to review. This record sheet will not be collected. It simply serves as a reference for the Project Superintendent and prepares Mini 4-H members for recordkeeping as regular 4-H members.

# Project Title: Mini 4-H Entomology

## Description of Mini 4-H:

Mini 4-H is a program designed to encourage positive development of children, Kindergarten through 2nd grade. The goal of Mini 4-H is to help young children explore friendships outside the family; explore the way in which things work; practice both small and large muscle control; and think about the ways people work together on projects. **Mini 4-H is non-competitive.** All Mini 4-H members will receive a Mini 4-H completion ribbon.

## Exhibit Guidelines:

All Mini 4-H projects will be entered the Thursday before the start of fair at the Jefferson County 4-H Fairgrounds. Each project should have an attached name tag. After the project has been entered, it will be displayed in a special Mini 4-H section of the Exhibit Hall.

Youth may exhibit any entomology project of their choosing. Mini 4-H members are encouraged to be creative and use their imagination. **Examples of possible Mini 4-H Entomology projects include but are not limited to;**

- **Entomology Poster** – (ex. display pictures of your favorite insect or spider, draw your favorite insect or spider, label the body parts of an insect or spider, describe why you like insects or spiders, etc.)
- **Entomology Notebook** - (ex. display pictures of your favorite insect or spider, draw your favorite insect or spider, label the body parts of an insect or spider, describe why you like insects or spiders, etc.)

Exhibitors should be considerate of space. Exhibits too large to safely move or requiring lots of space should be exhibited using photographs and a description of work in a notebook. Purdue Extension Jefferson County is not responsible for any broken or misplaced items.

Mini 4-H members should also bring their completed **Mini 4-H Record Sheet** to Project Check-In for Project Superintendents to review. This record sheet will not be collected. It simply serves as a reference for the Project Superintendent and prepares Mini 4-H members for recordkeeping as regular 4-H members.

# Project Title: Mini 4-H Floriculture

## Description of Mini 4-H:

Mini 4-H is a program designed to encourage positive development of children, Kindergarten through 2nd grade. The goal of Mini 4-H is to help young children explore friendships outside the family; explore the way in which things work; practice both small and large muscle control; and think about the ways people work together on projects. **Mini 4-H is non-competitive.** All Mini 4-H members will receive a Mini 4-H completion ribbon.

## Exhibit Guidelines:

All Mini 4-H projects will be entered the Thursday before the start of fair at the Jefferson County 4-H Fairgrounds. Each project should have an attached name tag. After the project has been entered, it will be displayed in a special Mini 4-H section of the Exhibit Hall.

Youth may exhibit any floriculture project of their choosing. Mini 4-H members are encouraged to be creative and use their imagination. **Examples of possible Mini 4-H Floriculture projects include but are not limited to;**

- **3 Cut Flowers in a Vase** – (arrange 3 cut flowers of your choosing in a vase and attach a label telling what kinds of flowers are in the vase.)
- **1 Flowering Plant in a Pot** – (exhibit a potted plant and attach a label telling what kind of plant is in the pot.)

Exhibitors should be considerate of space. Exhibits too large to safely move or requiring lots of space should be exhibited using photographs and a description of work in a notebook. Purdue Extension Jefferson County is not responsible for any broken or misplaced items.

Mini 4-H members should also bring their completed **Mini 4-H Record Sheet** to Project Check-In for Project Superintendents to review. This record sheet will not be collected. It simply serves as a reference for the Project Superintendent and prepares Mini 4-H members for recordkeeping as regular 4-H members.

# Project Title: Mini 4-H Foods

## Description of Mini 4-H:

Mini 4-H is a program designed to encourage positive development of children, Kindergarten through 2nd grade. The goal of Mini 4-H is to help young children explore friendships outside the family; explore the way in which things work; practice both small and large muscle control; and think about the ways people work together on projects. **Mini 4-H is non-competitive.** All Mini 4-H members will receive a Mini 4-H completion ribbon.

## Exhibit Guidelines:

All Mini 4-H projects will be entered the Thursday before the start of fair at the Jefferson County 4-H Fairgrounds. Each project should have an attached name tag. After the project has been entered, it will be displayed in a special Mini 4-H section of the Exhibit Hall.

Youth may exhibit a foods project of their choosing. All Mini 4-H Foods projects should be exhibited on a paper plate and covered with plastic wrap. **Examples of Mini 4-H Foods projects include but are not limited to;**

- **Peanut Butter Sandwich** – (ex. make a peanut butter sandwich on a paper plate)
- **Trail Mix**– (ex. make a trail mix snack displayed in a plastic bag)
- **3 No-bake Cookies** – (ex. make no-bake cookies and display 3 on a plate)
- **3 Marshmallow Treat Squares** – (ex. make marshmallow treat squares and display 3 squares on a plate)
- **Foods Poster or Notebook** – (ex. create a poster or notebook with pictures of you preparing food, a description of how to follow a recipe, etc.)

Exhibitors should be considerate of space. Exhibits too large to safely move or requiring lots of space should be exhibited using photographs and a description of work in a notebook. Purdue Extension Jefferson County is not responsible for any broken or misplaced items.

Mini 4-H members should also bring their completed **Mini 4-H Record Sheet** to Project Check-In for Project Superintendents to review. This record sheet will not be collected. It simply serves as a reference for the Project Superintendent and prepares Mini 4-H members for recordkeeping as regular 4-H members.

# Project Title: Mini 4-H Forestry

## Description of Mini 4-H:

Mini 4-H is a program designed to encourage positive development of children, Kindergarten through 2nd grade. The goal of Mini 4-H is to help young children explore friendships outside the family; explore the way in which things work; practice both small and large muscle control; and think about the ways people work together on projects. **Mini 4-H is non-competitive.** All Mini 4-H members will receive a Mini 4-H completion ribbon.

## Exhibit Guidelines:

All Mini 4-H projects will be entered the Thursday before the start of fair at the Jefferson County 4-H Fairgrounds. Each project should have an attached name tag. After the project has been entered, it will be displayed in a special Mini 4-H section of the Exhibit Hall.

Youth may exhibit a forestry project of their choosing. Mini 4-H members are encouraged to be creative and use their imagination. **Examples of possible Mini 4-H Forestry projects include but are not limited to;**

- **Diagram of a Tree** – (ex. create a diagram of a tree and label the parts)
- **Leaf/Bark Rubbings**– (ex. make a bark or leaf rubbing and label what type of tree it came from)
- **Forestry Poster or Notebook** – (ex. create a poster or notebook describing how trees impact the environment, what materials trees are used for, what types animals might live in trees etc.)

Exhibitors should be considerate of space. Exhibits too large to safely move or requiring lots of space should be exhibited using photographs and a description of work in a notebook. Purdue Extension Jefferson County is not responsible for any broken or misplaced items.

Mini 4-H members should also bring their completed **Mini 4-H Record Sheet** to Project Check-In for Project Superintendents to review. This record sheet will not be collected. It simply serves as a reference for the Project Superintendent and prepares Mini 4-H members for recordkeeping as regular 4-H members.

# Project Title: Mini 4-H Garden

## Description of Mini 4-H:

Mini 4-H is a program designed to encourage positive development of children, Kindergarten through 2nd grade. The goal of Mini 4-H is to help young children explore friendships outside the family; explore the way in which things work; practice both small and large muscle control; and think about the ways people work together on projects. **Mini 4-H is non-competitive.** All Mini 4-H members will receive a Mini 4-H completion ribbon.

## Exhibit Guidelines:

All Mini 4-H projects will be entered the Thursday before the start of fair at the Jefferson County 4-H Fairgrounds. Each project should have an attached name tag. After the project has been entered, it will be displayed in a special Mini 4-H section of the Exhibit Hall.

Youth may exhibit any garden project of their choosing. Mini 4-H members are encouraged to be creative and use their imagination. **Examples of possible Mini 4-H Garden projects include but are not limited to;**

- **3 Vegetables** – (ex. a plate with a maximum of 3 vegetables)
- **1 Herb Plant in a Pot** – (ex. an herb plant in a pot)

Exhibitors should be considerate of space. Exhibits too large to safely move or requiring lots of space should be exhibited using photographs and a description of work in a notebook. Purdue Extension Jefferson County is not responsible for any broken or misplaced items.

Mini 4-H members should also bring their completed **Mini 4-H Record Sheet** to Project Check-In for Project Superintendents to review. This record sheet will not be collected. It simply serves as a reference for the Project Superintendent and prepares Mini 4-H members for recordkeeping as regular 4-H members.



# Project Title: Mini 4-H Geology

## Description of Mini 4-H:

Mini 4-H is a program designed to encourage positive development of children, Kindergarten through 2nd grade. The goal of Mini 4-H is to help young children explore friendships outside the family; explore the way in which things work; practice both small and large muscle control; and think about the ways people work together on projects. **Mini 4-H is non-competitive.** All Mini 4-H members will receive a Mini 4-H completion ribbon.

## Exhibit Guidelines:

All Mini 4-H projects will be entered the Thursday before the start of fair at the Jefferson County 4-H Fairgrounds. Each project should have an attached name tag. After the project has been entered, it will be displayed in a special Mini 4-H section of the Exhibit Hall.

Youth may exhibit any geology project of their choosing. Mini 4-H members are encouraged to be creative and use their imagination. **Examples of possible Mini 4-H Geology projects include but are not limited to;**

- **Geology in a Jar** – (ex. create salt or sugar crystals in a jar, display your favorite rocks in a jar, etc.)
- **Rock Collection** – (ex. display a maximum of 12 rocks in your collection)

Exhibitors should be considerate of space. Exhibits too large to safely move or requiring lots of space should be exhibited using photographs and a description of work in a notebook. Purdue Extension Jefferson County is not responsible for any broken or misplaced items.

Mini 4-H members should also bring their completed **Mini 4-H Record Sheet** to Project Check-In for Project Superintendents to review. This record sheet will not be collected. It simply serves as a reference for the Project Superintendent and prepares Mini 4-H members for recordkeeping as regular 4-H members.

# Project Title: Mini 4-H Health

## Description of Mini 4-H:

Mini 4-H is a program designed to encourage positive development of children, Kindergarten through 2nd grade. The goal of Mini 4-H is to help young children explore friendships outside the family; explore the way in which things work; practice both small and large muscle control; and think about the ways people work together on projects. **Mini 4-H is non-competitive.** All Mini 4-H members will receive a Mini 4-H completion ribbon.

## Exhibit Guidelines:

All Mini 4-H projects will be entered the Thursday before the start of fair at the Jefferson County 4-H Fairgrounds. Each project should have an attached name tag. After the project has been entered, it will be displayed in a special Mini 4-H section of the Exhibit Hall.

Youth may exhibit a health project of their choosing. Mini 4-H members are encouraged to be creative and use their imagination. **Examples of possible Mini 4-H Health projects include but are not limited to;**

- **Nutrition** – (ex. create a poster or notebook explaining the importance of eating healthy, describe which healthy foods are your favorite, or create a display of MyPlate etc.)
- **Physical Activity** – (ex. create a poster or notebook explaining the importance of physical activity, what you like to do for exercise, etc.)
- **Safety** – (ex. create a poster or notebook describing a safety behavior such as handwashing, wearing a bicycle helmet, wearing a seatbelt, etc.)

Exhibitors should be considerate of space. Exhibits too large to safely move or requiring lots of space should be exhibited using photographs and a description of work in a notebook. Purdue Extension Jefferson County is not responsible for any broken or misplaced items.

Mini 4-H members should also bring their completed **Mini 4-H Record Sheet** to Project Check-In for Project Superintendents to review. This record sheet will not be collected. It simply serves as a reference for the Project Superintendent and prepares Mini 4-H members for recordkeeping as regular 4-H members.

# Project Title: Mini 4-H Pets

## Description of Mini 4-H:

Mini 4-H is a program designed to encourage positive development of children, Kindergarten through 2nd grade. The goal of Mini 4-H is to help young children explore friendships outside the family; explore the way in which things work; practice both small and large muscle control; and think about the ways people work together on projects. **Mini 4-H is non-competitive.** All Mini 4-H members will receive a Mini 4-H completion ribbon.

## Exhibit Guidelines:

All Mini 4-H projects will be entered the Thursday before the start of fair at the Jefferson County 4-H Fairgrounds. Each project should have an attached name tag. After the project has been entered, it will be displayed in a special Mini 4-H section of the Exhibit Hall.

Youth may exhibit a pets project of their choosing. Mini 4-H members are encouraged to be creative and use their imagination. **Examples of possible Mini 4-H Pets projects include but are not limited to;**

- **Pet Poster** – (ex. display pictures of your pet, explain how to take care of your pet, describe why you like your pet, etc.)
- **Pet Notebook** - (ex. display pictures of your pet, explain how to take care of your pet, describe why you like your pet, etc.)

Exhibitors should be considerate of space. Exhibits too large to safely move or requiring lots of space should be exhibited using photographs and a description of work in a notebook. Purdue Extension Jefferson County is not responsible for any broken or misplaced items.

Mini 4-H members should also bring their completed **Mini 4-H Record Sheet** to Project Check-In for Project Superintendents to review. This record sheet will not be collected. It simply serves as a reference for the Project Superintendent and prepares Mini 4-H members for recordkeeping as regular 4-H members.

# Project Title: Mini 4-H Sewing

## Description of Mini 4-H:

Mini 4-H is a program designed to encourage positive development of children, Kindergarten through 2nd grade. The goal of Mini 4-H is to help young children explore friendships outside the family; explore the way in which things work; practice both small and large muscle control; and think about the ways people work together on projects. **Mini 4-H is non-competitive.** All Mini 4-H members will receive a Mini 4-H completion ribbon.

## Exhibit Guidelines:

All Mini 4-H projects will be entered the Thursday before the start of fair at the Jefferson County 4-H Fairgrounds. Each project should have an attached name tag. After the project has been entered, it will be displayed in a special Mini 4-H section of the Exhibit Hall.

Youth may exhibit a sewing project of their choosing. Mini 4-H members are encouraged to be creative and use their imagination. **Examples of possible Mini 4-H Sewing projects include but are not limited to:**

- **Sewing Kit** – (ex. make a sewing kit and label the different tools. Sewing kits can be made with real items or pictures of the items)
- **Pin Cushion** – (ex. create a pin cushion without the pins)
- **A Sewn-on Button** – (ex. sew a button and display the item)
- **Throw Pillow** – (ex. create a simple throw pillow)

Exhibitors should be considerate of space. Exhibits too large to safely move or requiring lots of space should be exhibited using photographs and a description of work in a notebook. Purdue Extension Jefferson County is not responsible for any broken or misplaced items.

Mini 4-H members should also bring their completed **Mini 4-H Record Sheet** to Project Check-In for Project Superintendents to review. This record sheet will not be collected. It simply serves as a reference for the Project Superintendent and prepares Mini 4-H members for recordkeeping as regular 4-H members.

# Project Title: Mini 4-H Wildlife

## Description of Mini 4-H:

Mini 4-H is a program designed to encourage positive development of children, Kindergarten through 2nd grade. The goal of Mini 4-H is to help young children explore friendships outside the family; explore the way in which things work; practice both small and large muscle control; and think about the ways people work together on projects. **Mini 4-H is non-competitive.** All Mini 4-H members will receive a Mini 4-H completion ribbon.

## Exhibit Guidelines:

All Mini 4-H projects will be entered the Thursday before the start of fair at the Jefferson County 4-H Fairgrounds. Each project should have an attached name tag. After the project has been entered, it will be displayed in a special Mini 4-H section of the Exhibit Hall.

Youth may exhibit a wildlife project of their choosing. Mini 4-H members are encouraged to be creative and use their imagination. **Examples of possible Mini 4-H Wildlife projects include but are not limited to;**

- **Birdhouse or Bird Feeder** – (ex. create a birdhouse or bird feeder)
- **Wildlife Poster or Notebook** – (ex. create a poster or notebook about your favorite wild animal, describe any wildlife habitat, etc.)

Exhibitors should be considerate of space. Exhibits too large to safely move or requiring lots of space should be exhibited using photographs and a description of work in a notebook. Purdue Extension Jefferson County is not responsible for any broken or misplaced items.

Mini 4-H members should also bring their completed **Mini 4-H Record Sheet** to Project Check-In for Project Superintendents to review. This record sheet will not be collected. It simply serves as a reference for the Project Superintendent and prepares Mini 4-H members for recordkeeping as regular 4-H members.

# Appendices

## Special Fair Time Events

### **Jefferson County 4-H Queen Contest**

Rules and applications will be available from the Jefferson County Extension Office after June 15, 2023.

### **Jefferson County Farm Bureau Flower & Hobby Contest**

Any child 10 years old or younger, may exhibit flowers or hobbies. These will be exhibited in the Farm Bureau Building. Exhibits can be turned in Sunday, July 9<sup>th</sup> from 12:00 noon until 3:00 p.m. or Monday, July 10<sup>th</sup> from 12:00 noon until 2:00 p.m. Exhibits will be released on Saturday, July 15<sup>th</sup> from 12:00 noon until 2:00 p.m.

**Flower Exhibits.** Flower Exhibits shall be 3 blooms of any flower grown at home, either annual or perennial. Containers will be provided.

**Hobbies.** Children who are 10 years or younger can bring a display of one of their hobbies. Please try to cover this display with clean plastic. Labels will be available. The labels will include the child's name, parents name and address.

All children participating in the Flower and Hobby Show will receive a participation ribbon and a small monetary prize.

### **Jefferson County Farm Bureau Kiddie Tractor Pull**

Farm Bureau will sponsor a Kiddie Tractor Pull again this year. It is open to all children. It will be held on Wednesday, July 12 at the Farm Bureau Building.

Registration and weigh-in will be at 9:30 a.m. with the pull beginning at 10:00 a.m.

Parent's signatures are required for each child. The weight classes will be as follows: Up to 40 pounds, 41-55 pounds, 56-70 pounds, 71-85 pounds. Trophies will be given to winners and participation ribbons will be given to all. Contact the Jefferson County Fair Bureau at 273-3600 for more information. Check the Farm Bureau Building for any additional contests.

### **Jefferson County Tots & Tykes Contest**

Rules and applications will be available after June 15, 2023 at the Jefferson County Extension Office. They will also be available at the Fair Office and at the contest.

### **Jefferson County 4-H Livestock Auction Dinner**

**Date:** Friday, July 14 at 5:00 p.m.

**Location:** Community Building

**Sponsored by:**

Jefferson County Farm Bureau, Inc.  
Jefferson County Fair Board

Tickets will be on sale starting Wednesday, July 12, 2023 at the Fair Office. A limit of 450 tickets will be sold, including complimentary. Each person purchasing an animal at the 4-H Auction (one ticket per animal bought) will receive a complimentary ticket. There will be 2 tickets given to each County Farm Bureau Board member, each Fair Board member and each County Extension Educator. All complimentary tickets (except buyers) must be picked up by noon on Wednesday, July 12, 2023. The price of Auction Dinner tickets will be set in July.

## Special Awards Offered

### ***WORX FM/WXGO AM Outstanding Exhibitor Award***

A member can only win this award once. An achievement trophy will be awarded to 2 (two) 4-H'ers on the basis of the following fair achievements:

2 pts. For each completed project (With completed record sheet)

5 pts. For each Champion

15 pts. For each blue ribbon

10 pts. For each red ribbon

5 pts. For each white ribbon

*Maximum 2 Top Ribbons per project.*

Five (5) points will be deducted for each project taken, but not completed.

### **Outstanding 4-H Club Award**

The Outstanding 4-H Club Award is presented to a 4-H Club that has exhibited outstanding participation in community service and additional 4-H activities. These activities include but are not limited to the Pumpkin Painting Contest, Barrel Painting Contest, and the 4-H Club Challenge. Placement in these competitions is also considered. In addition, only 4-H Clubs who have completed their annual **4-H Club/Unit Financial Report** and the **4-H Unit Activity Report** by May 15<sup>th</sup> of the current program year will be considered for the award.

### **Pam Wehner Mental Attitude Award**

This award is based on attitude of members. The leaders in each club can select two members to compete. The leaders write a short resume with picture and submit it to the Fair Office by the last Friday of Fair

Week by noon. All 4-H leaders and Fair Board members may vote on the members submitted. Votes must be submitted by the start of the Saturday Awards program. The Fair Board will break all ties. The Wehner family sponsors a plaque to be displayed in the Jefferson County Extension Office with the winner's name. The Junior Leaders sponsor a trophy to the winner.

### **William & Pauline Hutchinson Memorial Award**

*Sponsored by Mr. & Mrs. John Hutchinson*  
For Sheep Project participants only.

The purpose of the award is to encourage participation and completion of the 4-H Sheep project and other 4-H projects. 4-H members that accumulate the highest number of points under the following criteria will receive a Cash Award and an engraved plaque. Criteria:

1. 4-H members must complete either the sheep breeding or market lamb project and 3 other unrelated 4-H projects.
2. Complete a 50-question test on the areas of sheep production, care of sheep, and showmanship techniques, given on Monday of fair at 10:00 a.m. If this time does not fit into your schedule, please contact the Fair Office.
3. Point value of highest ribbon of each project and all sheep ribbons:

Blue – 5 pts, Red – 3 pts, White – 2 pts,  
Champ – 2 points, G Champ – 1 pt, C  
Showman – 5 pts, R Showman – 3 pts

**A member can only win the award once.  
In case of a tie, the test score will break the tie.**

# Scholarship Opportunities

## 4-H Development & Scholarship Fund

Jefferson County 4-H'ers, 4-H Fair Board, and the Community Foundation of Madison and Jefferson County, Inc. have joined resources to establish a permanent Endowment Fund.

The Endowment Fund includes:

- 4-H Development Fund – used for 4-H Fairgrounds improvement and to support 4-H'ers for trips, camp, and conferences.
- 4-H Scholarship Fund – Scholarships are awarded to 4-H'ers who wish to attend college or trade school after graduation.

The Community Foundation administers the 4-H Endowment which grants money to 4-H while returning capital gains to the fund to protect its purchasing power. Respected members of the community make up an Advisory Board who decide exactly how the proceeds from the fund will be spent. Donors can designate their money to go to Scholarships and/or Development.

We encourage you to become a donor to the 4-H Development & Scholarship Fund. Your donations will be recognized publicly for your support of the Jefferson County 4-H Program.

Any one wanting to donate directly to the Fair Board is also welcomed. You can identify exactly how you want your donation to be used.

## Suzie Smith Broadhead Scholarship for Sheep Members- \$300.00

The Suzie Smith Broadhead Scholarship is sponsored by her parents, Dave and Judy

Smith. Suzie loved showing Sheep and showed for 10 years here in Jefferson County and at the Indiana State Fair.

Applicants will be seniors in high school who have shown Sheep in Jefferson County for four years counting the year they are a senior. Scholarship will be based on the Sheep project and other projects taken while in 4-H. Applicants will write an essay (at least 150 words) about their 4-H work in the Sheep project, why they took sheep and what it has done for them. A list of all other projects taken will need to be attached.

Essay and papers are due at the Fair Office on Monday of the Fair.

## Jefferson County 4-H Scholarships

In addition to the 10 year member scholarship the Jefferson County 4-H Fair Board and Extension Board gives a separate merit based scholarship. This scholarship is a part of the community foundations application and is due in early spring. All seniors are encouraged to apply through the Community Foundation website. Contact your school counselor to help you access the application.

## Indiana 4-H Scholarships

In partnership with the Indiana 4-H Foundation, the Indiana 4-H Youth Development Program annually awards more than \$125,000.00 in scholarships to 4-H members to pursue post-secondary education. Scholarships are awarded to recognize youth participating in Indiana's 4-H Youth Development Program on their achievements and life skill development resulting from their participation in a variety of 4-H experiences. These scholarships can be accessed on 4-H Online events tab and are due at the end of January each year. Contact your extension educator to learn more.



# MEMORIALS

The Jefferson County 4-H Fair Board accepts Memorials. Those having memorials of \$50 or more (money left in their name) will be inscribed on a plaque to be displayed in the Community Building. The following names are listed on the plaque:

Bennett Adams	Don Gasert	Connie Mahoney
Delores Aich	E.A. Goley	Leona Market
Jean Andres	Dennis Gray	Tom Matthews
Pat Bechman	Marjorie Smith	Andrew McDaniel
Nancy Besse	Dr. G.E. Hamilton	Cecil Moore
Jacko Bohlander	Bill Ringwald	George Morgan
Norvella Bonner	Karin Hamilton	Leah Nelson
Bruce Breeding	Mrs. Claude Hardy	Patricia Newman
Suzie Smith Broadhead	Nellie Harrell	Charles Pate
Asa Gilbert Buchanan	Everett Hay	Pauline Patrick
Jennifer Burnham	Richard Heck	Margaret Phillips
Robert Burris	Beverly Herin	Robert Phillips
Orneta Butler	Ralph Herin	Harriet Sanders
Nell Cayton	Mary Hensler	Larry Sedam Sr.
Janice Chandler	Ruth Higbie	Ira Thomas Sharon
Kim Coles	Anna May Hord	Marjorie Smith
Marjorie Coles	Don Hord	Gene Stockdale
Tyler Cooley	Marshall Hord	Justin Ricke
Jerry Coy	John Hunter	Bill Ringwald
Jack Crabtree	Elizabeth Keller	Jack & Betty Rogers
Ruby Craig	Gwen Keller	Josephine Schoolcraft
Delores Dahlem	Harry C. Keller	Chap Stites
Charles Deputy	William Keller	Joan Thom
Jean Deputy	Helen Kreeger	Betty Wehner
Helen Donovan	James Lanham	Gerald Wesley
Earl Elston	Donna Layne	Wehner
Forest Ferguson	Gene Lewis	Josephine Wehner
Katherine Ferguson	Charles Little	John Evan Wehner
Samuel Fritter	Dennis Lyon	Vernon Wynn

## 2022 Special Contributors

FARM BUREAU, INC.

Sponsors of 4-H Grand Champion T-shirts at the Fair. Co-sponsor of Adult Leader Recognition Dinner. Co-sponsor of Auction Dinner at the Fair. Free ice cream cone to all 4-H'ers. 2022 Exhibit Hall refurbishment sponsor.

\*JAMES WEHNER FEED & SEED

Donated cash award to Grand Champion and Reserve Grand Champion Gilt exhibitor.

\*BAXTER LUMBER L.L.C.

Donated a cash award for Grand Champion and Reserve Grand Champion in Forestry presented at the auction. Also donated sawdust for animal bedding during fair week.

**\*ELSTON FARMS**

Donated a cash award to the Grand  
Champion Ewe exhibitor.

**\*ELSTON DAIRY GOATS**

Donated a cash award to Grand Champion  
& Reserve Grand Champion Dairy Goat.

**\*JEFFERSON CO.EXTENSION  
HOMEMAKER CLUBS**

Donated cash award to Grand Champion  
Foods project exhibitor and Grand  
Champion Sewing project exhibitor.

**\*BIG CREEK SIMMENTAL-BOBBY &  
KATHY PHILLIPS**

Donated cash award to Grand Champion and  
Reserve Grand Champion Heifer exhibitors.

**\*JERRY & BESS ADAMS**

Donated a cash award to all Champion Gilts.

**\*RILEY GASPER INSURANCE**

T-shirt award for all Round Robin  
participants.

## Jefferson County 4-H Adult Volunteers 2023

The Jefferson County 4-H Fair Board and the Extension staff wish to express our “THANKS” to our 4-H Adult Volunteer Leaders. \*\*New leaders may be approved after the date of this book.

Jennifer Abbott  
Karla Backus  
Nathanael Ball  
Jason Beavers  
Carrie Bechman  
Chance Bechman  
Erica Bechman  
Jacob Bell  
Becky Bladen  
Deana Boscia  
Amanda Briggs  
Brad Briggs  
Penny Jo Brim  
B.J. Cain  
Bill Cain  
Cuyler Cain  
Julie Cain  
Dorothy Canada  
Steve Canada  
Jeanna Carter  
Mark Cash  
Tara Cash  
Aaron Clayton  
Emerson Coles  
Emmy Coles  
Krista Coles  
Annie Copeland  
Brittany Copeland  
Trina Copeland  
Jill Deputy  
Alinza Deuser  
Kelsey Eisert  
Judy Elston  
Crystal Field  
Carrie Floyd  
Renee Glunt  
Brandy Graham  
Ashley Gray  
Brent Gray  
Brice Gray

Caitlyn Gray  
Linda Gray  
Tonya Gross  
Annamae Harmon  
Erika Hazelwood  
Michael Hazelwood  
Regina Hazelwood  
Keesha Hill  
Brittany Hitchel  
Crystal Hord  
Danica Houze  
Gabrielle Hubbard  
Michelle Hubbard  
Savannah Hubbard  
Scott Hubbard  
Taylor Hubbard  
Zach Hubbard  
Heather Huff  
Chris Imel  
Tristan Imel  
Misty Jacobs  
Logan Jines  
Jennie Keller  
William T. Keller  
Adam King  
Laramie King  
Tori Laub  
Bridget Leach  
Ryan Leach  
Cindy Mack  
Tanner Mahoney  
Mandi Marshall  
Tim McDonough  
Mary Mehl  
Bill Miller  
Jessica Morrison  
Alexis Napier  
Joe Neher  
Mischell Neher  
Tia Oberhausen

Aimee Perry  
Bart Phillips  
Binnie Phillips  
Terry Phillips  
Jennifer Ransom  
Alysha Reece  
Cassandra Rudolph  
Debbie Royalty  
Sara Schafer  
Sharon Schafer  
Shelby Schafer  
Vicky Schirmer  
Larry Sedam  
Tammy Sedam  
Kelly Seel  
Alyssa Shelton  
Ashley Shepherd  
Linda Shimfessel  
Melinda Shimfessel  
Carrie Simpson  
Dave Smith  
Judy Smith  
Shanna Smith  
Amy Stuart  
Connie Thomas  
Brienne Vigar  
Susan Ward  
Melissa Waller  
Brad Wehner  
Brandon Wehner  
Brent Wehner  
Julie Wehner  
Mary Ellen Wehner  
Megan Wehner  
Whitney Wehner  
Amanda Whalen  
Amy Wheeler  
Anthony Wheeler  
Sarah Williams

## 2022 Trophy Sponsors

A & K Beauty Shop  
 Aaron & Greta Clayton Family  
 Abigail Phillips  
 Alenza & Tyler Deuser  
 Alexis & Bo Napier  
 Amy Jo Wheeler  
 Andersons' Sales & Services  
 Annie & Jason Copeland  
 Ashley & Cory Owen  
 Arnold & Ruth Curry  
 Auxier Gas Service, Inc.  
 Barbara Kelly- BB DD Ranch  
 Bechman Family Farm, Chance & Carrie Bechman  
 Benny & Robin Hassfurd  
 Bill & Ginger Sexton  
 Bill & Gwen Keller  
 Billy Bob & Kristin Miller  
 Black Diamond Farm  
 Bo & Alexis Napier  
 Bob & Debbie McKenzie  
 Bobby & Kathy Phillips  
 Bobby & Mary Shepherd  
 Boonie's Water Conditioning Inc.  
 Brandon Brawner & Family  
 Brawner Family Farm  
 Brian, Caleb & Claire Phillips  
 Brice Gray- Farm Bureau  
 Bridget & Jordan Leach  
 Cain Farms  
 Caleb, Claire, Cora & Wyatt Phillips  
 Camille & Ryan Leach  
 Champs Sports & Corporate Apparel  
 Chris & Tristan Imel Family  
 Clifty Garden Center  
 Colen Insurance Agency  
 Country Sawdust, Billy & Jennie Keller  
 Danny & Alyssa Shelton  
 David & Judy Smith  
 Deputy 4-H Family & Friends 4-H Club  
 Deputy Self Storage  
 Deputy's Performance Horses  
 Deputy Yard & Garden- Dale Armstrong Family  
 Don Phillips of Hilliard Lyons  
 Dr. Joy Barron, DMV  
 Dr. Ivan Rimstidt & Family  
 Dr. Pat & Dr. Sue Stack  
 Elston Farms  
 Farm Bureau, Inc.  
 Farm Bureau Insurance  
 Farm Credit Services of Mid-America  
 Ferguson Auctions  
 Ferris Rare Breed Poultry Farm  
 First Financial  
 Gary & Linda Shimfessel

Gerald & Debbie Barnes  
 German American Bank  
 Gray Show Pigs  
 Gilbert & Paula Black  
 Hammersley Farms  
 Home Grown 4-H Club  
 "In Memory of Connie Mohoney"  
 "In Memory of Dani Riley"  
 "In Memory of Dennis Gray"  
 "In Memory of Josephine Schoolcraft"  
 "In Memory of Kim Coles"  
 "In Memory of Pat Bechman"  
 "In Memory of Tricia Newman" - Bub & Lonnie Birge  
 "In Memory of Tre Colber"- Kloss Family  
 "In Memory of William & Pauline Hutchinson"  
 Jakob, Isaak & John Bachmann  
 James Wehner Feed & Seed  
 Jason & Mary Ellen Wehner  
 Jefferson County Democratic Party  
 Jefferson County Extension  
 Homemakers  
 Jefferson County 4-H Junior Leaders  
 Jefferson County Republican Party  
 Jerry & Bess Adams  
 Jessica, Jordan & Jacob Bell  
 Jill Deputy  
 Jim Elston Family  
 Jimmy Long  
 Joe Neher Family  
 John & Kim Garland  
 John & Mary Wilson  
 John & Marilyn Hutchinson  
 John & Rhonda Noel  
 John & Vicki Wehner Family  
 Judy Elston  
 Keegan Gross  
 Keith & Karen Howard  
 Koehler Tire & Supply Inc.  
 Krista & Kody Coles  
 Kyndal Ashcraft  
 Lakyn Wilson  
 Lane Coles  
 Larry & Tammy Sedam  
 Lewis Fritter  
 Luke, Jake & Allie Coles  
 Marshall Club Lambs & Pigs  
 Manek Taxidermy- Jennifer & Jarrett Manek  
 Mark & Tara Cash  
 Marshall Farm LLC  
 Matthew Brawner & Family  
 Mckinlie, Laykyn, Caroline & Cole Bechman  
 Melinda Shimfessel

Michael & Addison Brawner  
 Mid-Cities Overhead Doors  
 Mike Koehler, Farm Bureau Insurance  
 Mike & Linda Wehner  
 Michael & Allie Briggs  
 Michael & Landon Gross  
 Milk Marketing, Inc.  
 Mr. & Mrs. Stan Phillips  
 Napier Trucking LLC- Alexis & Bo Napier  
 Ohio Valley Meat Processing  
 Penny & Tony Gordon  
 Pets Doc Veterinary Clinic  
 Pettitt & Associates, INC  
 Rathert's Forestry Service  
 Ridge Top Treeing Walkers  
 Riley-Gasper Crop Insurance Agency, INC.  
 Rob & Rhonda Hutchinson  
 Rocking H Farm- Jerry & Lola Hay  
 Rodney & Darla Mahoney  
 Ron & Wanda Thacker  
 Ryan Cash  
 Sayo Canine Services  
 Scott & Michelle Hubbard Family  
 Shari Stites  
 Sheila Adams – In Memory of Bennett Adams  
 Short's Farms & Family  
 Simmons Physical Therapy  
 Simple Farm Life Boutique  
 Soil & Water Conservation District  
 Southeastern IN Shorthorn Assoc.  
 Steve Canada  
 Steve & Delores Barnes  
 Stoney Ridge Farm  
 Tanner & Sarah Mahoney Family  
 Taylor Alvarez  
 Taylor & Kelsey Eisert  
 Taylor & Zach Hubbard  
 Teresa Keller  
 Terry & Binnie Phillips  
 Terry & Kathy Taylor  
 The Keller Families  
 The Bill Hensler Family  
 The Wilber & Schirmer Families  
 The Woodfill Farm  
 TNT Tool & Equipment Rental  
 Todd Bruther Farm  
 Tom & Carolyn Kemp  
 Tony & Montica Brawner  
 Tyler Yarling  
 Walton Creek Farms  
 Waltz Animal Clinic  
 Wanda Blair, Hoosier Hills Reality  
 Wayne & Billie Jo Fields  
 WORX & WXGO Radio

## 4-H Poster Pointers

- Poster is **22"x28"**
- Poster is displayed **horizontally**.
- Poster is placed in a clear plastic sleeve or covered with clear plastic to protect contents.
- Poster has a **5 ½"x2 ¾"** space available in the lower right-hand corner to place a FairEntry Exhibit Tag provided by Purdue Extension Office Staff. This tag should be taped to the **outside of the plastic**. Do **NOT** tape the FairEntry Exhibit Tag to the poster board.
- Poster has the standard County Information Label positioned on the lower right-hand corner. The tag should be no larger than **5 ½"x2 ¾"**. Place this tag **directly on the poster board**. Reference the following page for the County Information Label.
- Poster has a reference list positioned on the back of the poster. This reference list indicates where information was obtained, giving credit to the original author.

### 4-H Poster Example

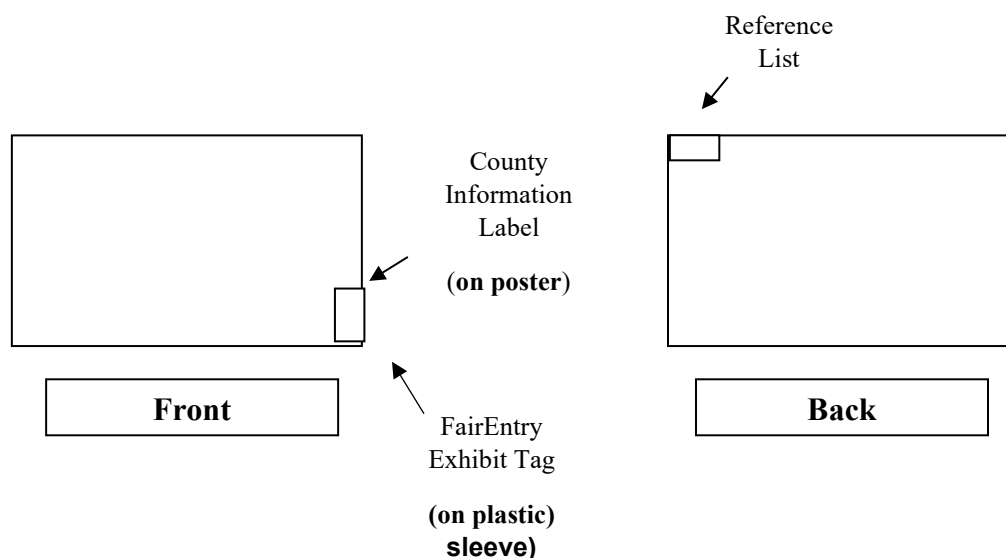

### FairEntry Exhibit Tag

- The Purdue Extension Office Staff will print a FairEntry Exhibit Tag for each exhibit prior to the county fair. These tags should be picked up by the 4-H member or their family at the Extension Office prior to Project Check-In. Please display the FairEntry Exhibit Tag in the right-hand corner of the front of the poster as shown on the 4-H Poster Example above. This tag should be taped to the **outside of the plastic**. Do **NOT** tape the FairEntry Exhibit Tag to the poster board.

## Reference List

- All posters, notebooks, and display boards must include a reference list indicating where information was obtained, giving credit to the original author, to complete the 4-H member's exhibit. This reference list should/might include web site links, people and professional interviews, books, magazines, etc. It is recommended this reference list be attached to the back of a poster or display board, be the last page of a notebook, or included as part of the display visible to the public. A judge is not to discredit an exhibit for the way references are listed.
- For assistance with the reference list, please refer to the Purdue Online Writing Lab [https://owl.purdue.edu/owl/purdue\\_owl.html](https://owl.purdue.edu/owl/purdue_owl.html) or contact the Extension Office at (812)265-8919.

## County Information Label

Jefferson County
Name _____
Project _____
Division _____
Grade _____
Club _____

Jefferson County
Name _____
Project _____
Division _____
Grade _____
Club _____

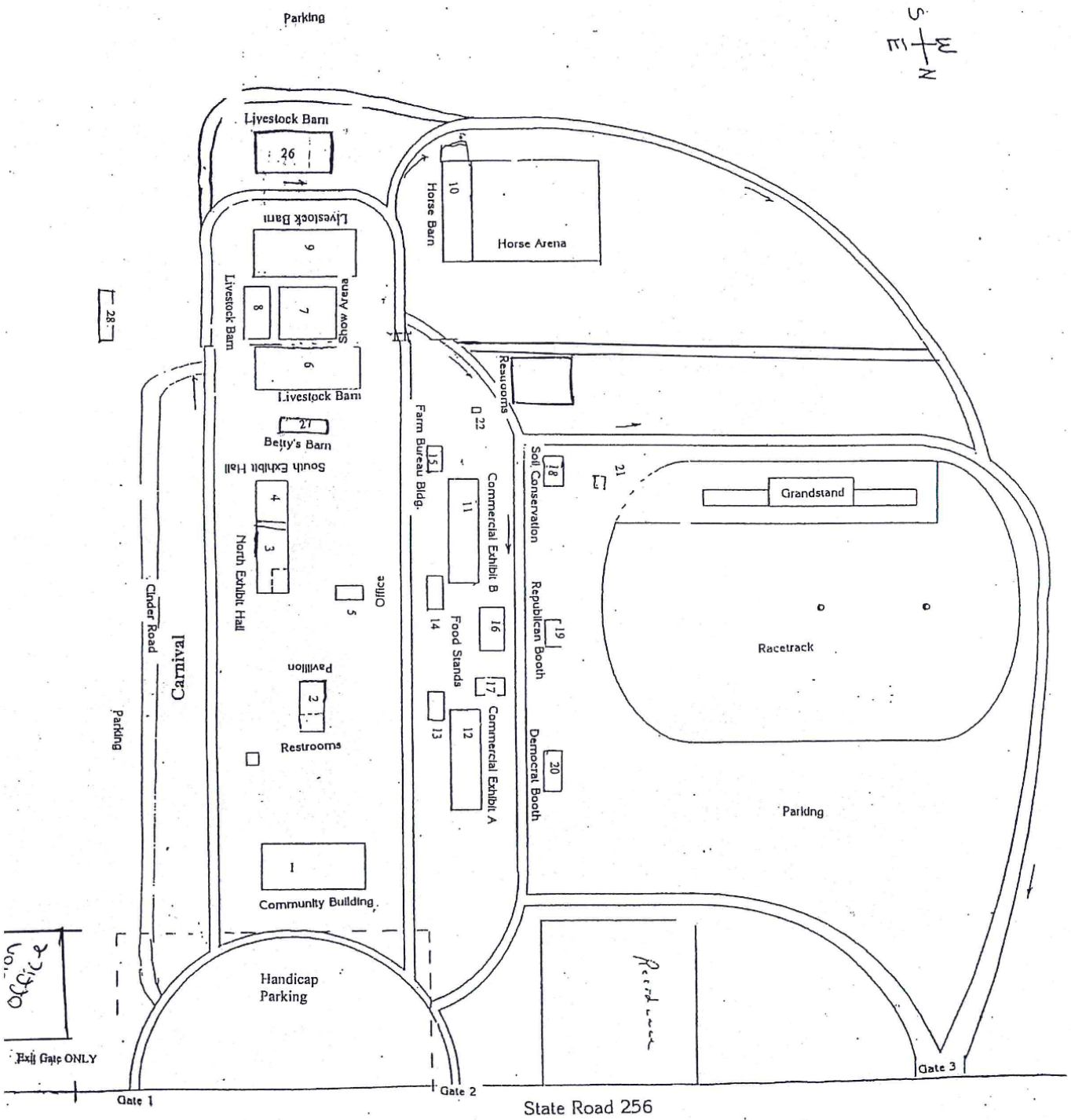
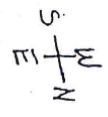

27/19/90  
Exit Gate ONLY

State Road 256

## **4-H Mission:**

The Indiana 4-H Youth Development mission is to provide real-life educational opportunities that develop young people who will have a positive impact in their communities and the world.

## **4-H Pledge:**

I pledge my head to clearer thinking,  
My heart to greater loyalty,  
My hands to larger service,  
and my health to better living,  
for my club, my community, my country, and my world.



## **Contact Information:**

Purdue Extension Jefferson County  
(812) 265-8919  
3767 W SR 256 Madison, IN 47250